

| | |
|--|--------------|
| Site Location / Drawing Title | |
| College Road @ jnc The Greenway Middlesbrough, TS3 9ER | |
| Client: Northern Gas Networks | |
| Contract No | DR4208 |
| Date | 11/07/2022 |
| Drawn by | DR |
| Purpose of works Gas works | |
| Version Number | 001 |
| Amended By | xxxxxxxxxx |
| Amendment Date | xx/xx/xxxx |
| Scale | NOT TO SCALE |
| Sheet No | 1 of 2 |

| | | |
|--|-----|------|
| SPEED OF ROAD | MPH | 30 |
| DISTANCE FROM FIRST SIGN TO START OF SITE(D) | MIN | 20m |
| | MAX | 45m |
| SIDEWAYS SAFETY ZONE (S) | | 0.5m |
| LONGWAYS CLEARANCE (L) | | 0.5m |

- KEY**
- Traffic sign
 - Traffic cone
 - No Parking cone
 - Traffic signals
 - Perm signal head
 - Working Space
 - Controlled area
 - Pedestrian Barrier
 - Pedestrian crossing
 - Bus Stop

| PHASE 1 | | PHASE 2 | |
|---------|----|---------|----|
| GO | | GO | |
| R | 15 | R | 5 |
| G | 40 | G | 40 |
| PHASE 3 | | | |
| GO | | | |
| R | 5 | | |
| G | 35 | | |

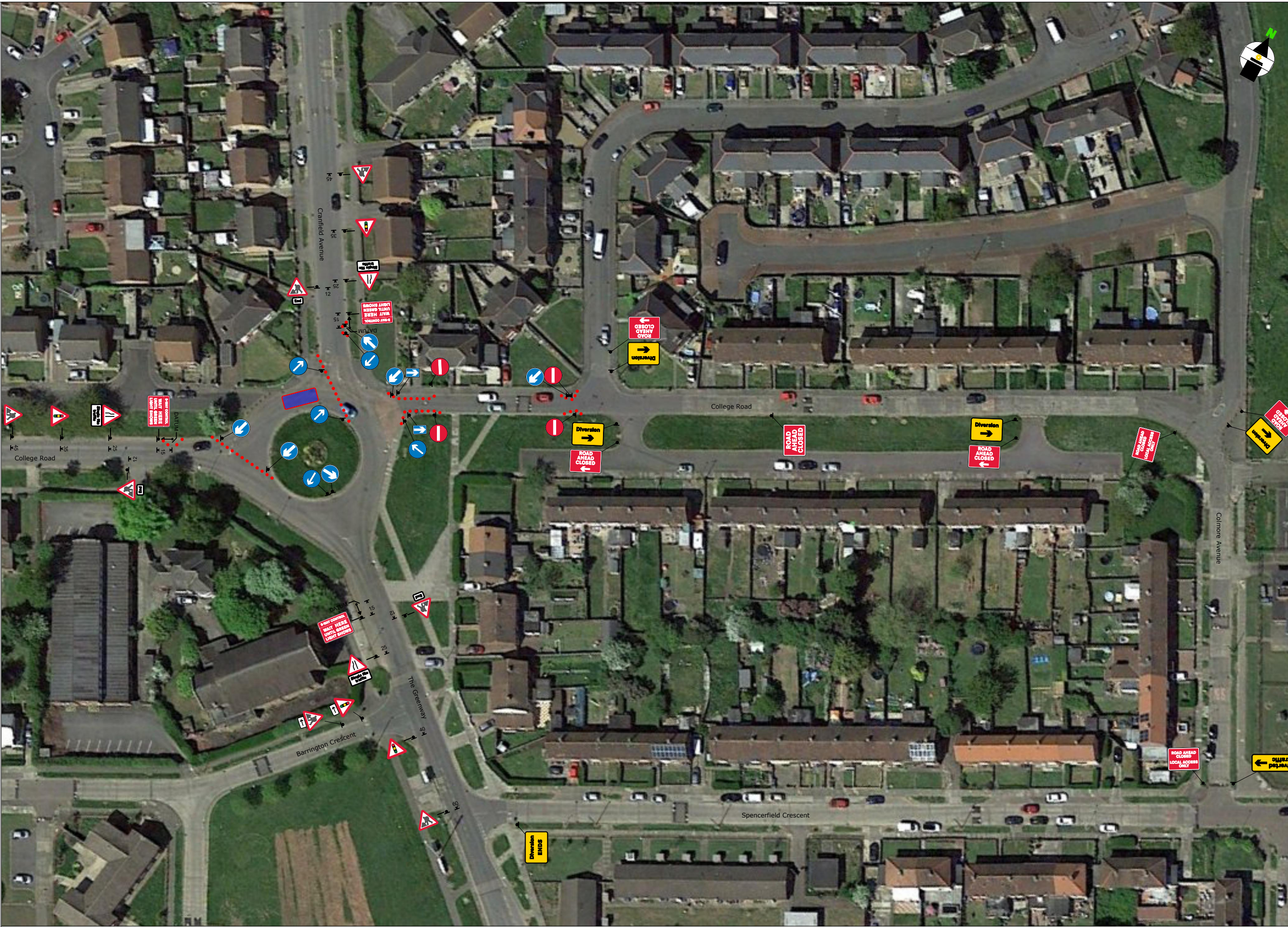
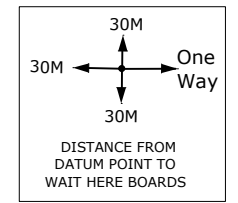

THIS DOCUMENT IS UNCONTROLLED WHEN PRINTED
The electronic version of this document is the approved and most current.
Any printed version is uncontrolled and may not be current.

The information in this drawing may not be copied or used by third parties without written consent from Sunbelt Rentals Ltd (Traffic Management).
This layout is for installation by NRSWA qualified persons.
All works shall be in accordance with Safety at Street Works and Road Works, A Code of Practice (2013) & Chapter 8